

PUBLIC AUCTION

Annville Area

27 + Acres of Prime Development Land

Tuesday, April 21, 2009 @ 11:00AM

North side of Louser Road, South Annville Township, Lebanon Co.

From Annville take Rt. 934 South, turn right onto Louser Road, go ¾ mile & turn right onto Jeffsu Drive.

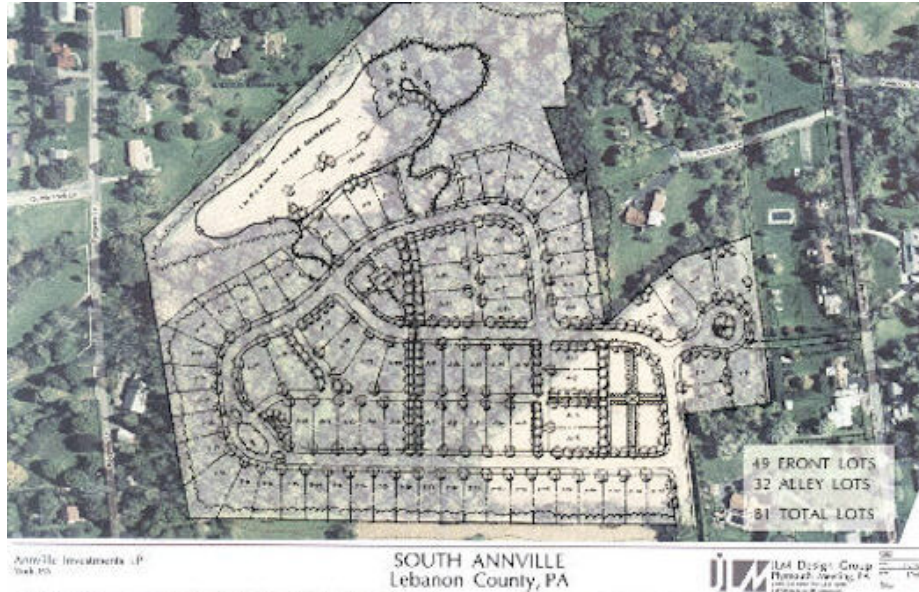

Conceptual Drawing

REAL ESTATE CONSISTS OF: 27+ acres, partially open and wooded land. A proposed concept plan of 81 lots is available for review. 35 sewer EDU's have been reserved with South Annville Township and are included in the sale.

Zoned R-1, Residential

Call Auctioneer for additional information.

Terms: 10% down day of sale; settlement within 45 days.

Terms By: Annville Investments, L.P.



Merle Eberly 610 286-5183

Alvin & Elton Horning • 2417-L • C. Ivan Stoltzfus CAI

www.horningfarmagency.com